

JET *Stainless steel self-priming centrifugal pump*

JET

Stainless steel self-priming centrifugal pump

Definition of model

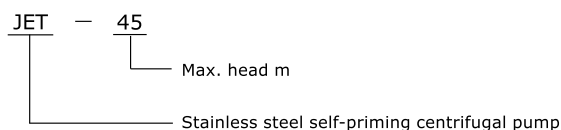

Applications

Applied to pumping thin, clean, non-flammable and non-explosive liquid containing no solid granules and fibers. Such as:

- Tank filling
- Domestic water supply
- Water transfer
- Boosting

Features

- Self-priming jet centrifugal pumps provides higher pressure and good suction ability
- Pump body and impeller and so on are made of stainless steel, venturi is made of plastic with high intensity and abrasion proof.
- TEFC motor, built-in thermal overload protector easy and safe to operate.
- Screwed thread suction and discharge, easy and quick to install.
- Simple structure, less parts, easy to maintain and service.

Technical data

	JET-45	JET-35
Max. suction head		7 m
Liquid temperature		+45°C
Max. ambient temperature		+40°C
Max. pump casing pressure		0.6 MPa
Inlet size		G1
Outlet size		G1

Material table

Parts	Casing	Impeller	Shaft	Rotating	Stationary	Venturi	O-Ring	Motor house
Materials	SS 304	SS 304	SS 304	Ceramic	Carbon	PP+GF	NBR	Aluminum alloy

Electrical data table

Model	Power	Voltage/Current		Frequency	Speed	Protection class
		Single-phase	Three-phase			
JET-45	0.55kW	220V/3.65A	220V/2.22A	50Hz	2900r/min	IP55
JET-35						

Performance table

Model	Driving motor (kW)	Q(m ³ /h)	H(m)						
			0	0.6	1.2	1.5	1.8	2.4	3.0
JET-45	0.55	H(m)	45	35	28	25	23	19	15
JET-35			35	28	23	20	19	16	

Outline and installation dimension (equipped with single-phase motor)

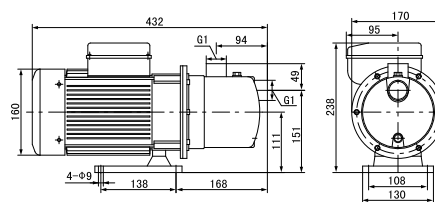

Outline and installation dimension (equipped with three-phase motor)

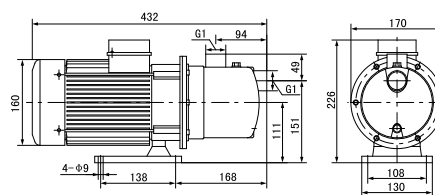

Performance curve

